



Climate FORTH Development Phase Works: Natural Heritage Assets Baseline Survey, Options Appraisal & Site Designs

RSPB / Inner Forth Futures

Appraisal Report

This report has been prepared by:



Author : SDS
Checked by: SR
Date: 16/09/2022
Revision: A
Reference: 2220/IFF Natural Heritage Assets Draft
Report/28072022



Landscape Appraisal for Preferred Site

Rannoch Park, Grangemouth, Falkirk Council

Rannoch Park, Grangemouth

The selected Falkirk Council site is Rannoch Park in Grangemouth. It is an existing park of 79,000m² with a residential area to the north and A905 Beancross Road and M9 bounding the southern and eastern boundaries. The western boundary meets the Grange burn.

The northern boundary of the park has a linear, canalised flood relief channel and a footbridge provides access into the park over this channel. The channel could lend itself to improvements through this project, however it is within the Grangemouth Flood Prevention Scheme study area so no proposals are made under this project. The channel is bound by a line of mature Ash trees between the road and adjoining housing. The ash trees are suffering from die back (*Hymenoscyphus fraxineus*) and a succession plan to eventually replace the loss of these trees is recommended.

The park is mostly laid out as amenity grass with two football pitches in the most central areas, one formal (to the west) and one informal (to the east). There is a pavilion associated with the pitches.

There is a recently installed play park in this central part as well, however it does not integrate well with the surrounding park amenity landscape and is constrained by a bow top fence surrounding the play.

The margins of the park have a more relaxed mowing regime and some recently planted specimen trees line the main paths through the park. The paths follow the edges of the park in the main with one north south aligned path bisecting the middle of the park. The park appears underused, undervalued, and lacking in a variety of activities with limited biodiversity.

The southern and eastern edges of the park have some existing broadleaf tree cover, although this is thin in places and forms an inadequate barrier to the noise, visual movement of vehicles and associated air pollution. If this environmental buffer was strengthened it would improve the experience for those using the park as well as strengthening this habitat corridor for wildlife.

Two wet areas are identified, which appear on SEPA surface water flood mapping. Rannoch park also lies in an area that is associated with river flooding due to its proximity to the Grange Burn.

Careful selection of woodland tree, scrub and glade species will be required in the south-east corner of the site to deliver the environmental benefits while adhering to constraints associated with the Ineos pipeline

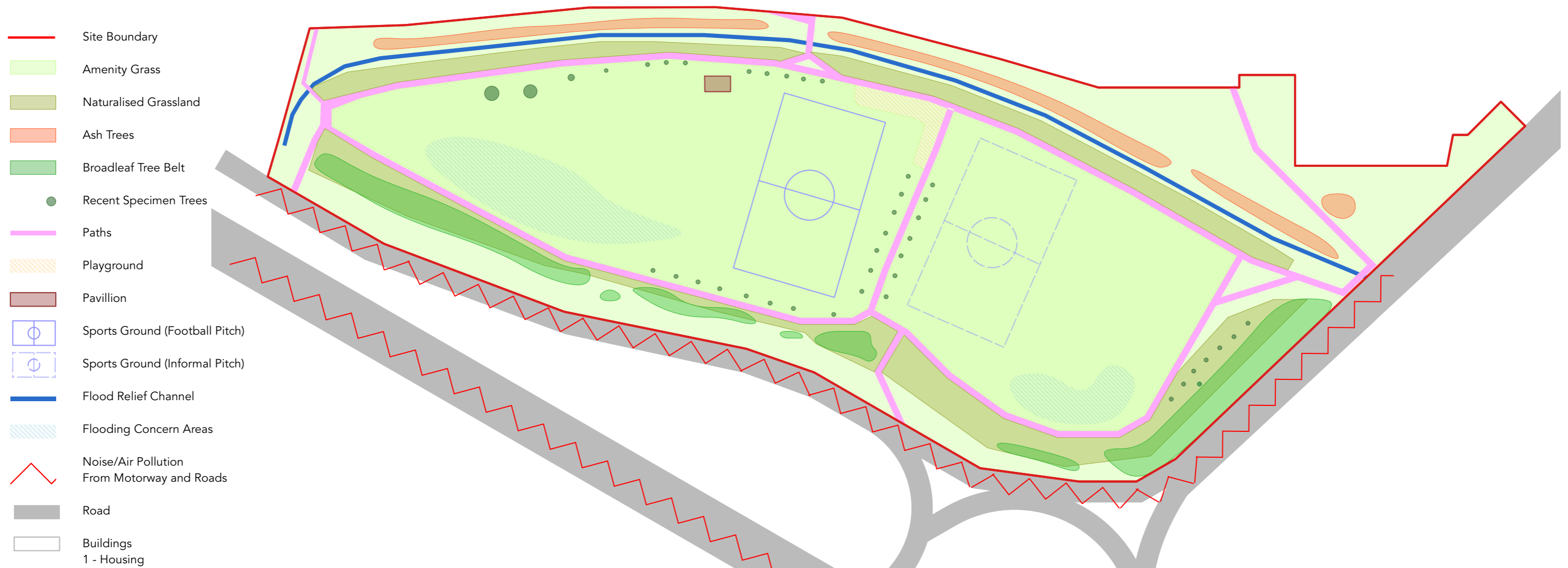

Concept & Key Principles

Rannoch Park, Grangemouth, Falkirk Council

- Strengthen environmental buffer between the park and roads to the southern edge with woodland expansion to mitigate negative impacts of noise / air pollution and reduce visual movement of vehicles and reduce flood extent area
- Diversity in walking opportunities; southern paths through woodland provide cooling shaded walks in hotter summers
- New orchard planting; incorporating an edible landscape into the park
- Wetland scrape in the western part of the site to accommodate surface water flooding and additional habitat
- Provide more diversity in planting and seasonal interest
- Improve plant health resilience by succession planting of specimen trees on the northern edge to replace those suffering Ash Die-back. This work will not be part of the site improvements during 2024 and will be delivered at a later date to tie in with flood relief work.

